

Asqelio™

bioli™ IOL Delivery System

SAFE, PRECISE AND CONTROLLABLE

Ergonomic design, applicable to single-handed operation, is developed to enable a safer, simpler and more effective intraocular lens (IOL) delivery.

INNOVATIVE LubriMATRIX™ TECHNOLOGY

The disposable LubriMATRIX™ treated cartridge protects an IOL from damage during IOL delivery, prevents particulate contamination, and provides smooth delivery experience.

SECURE INCISION

Minimizing stretching of incisions which are as small as 2.2 mm (BIOLI-D) and 2.8 mm (BIOLI-C)

bioli™
IOL Delivery System

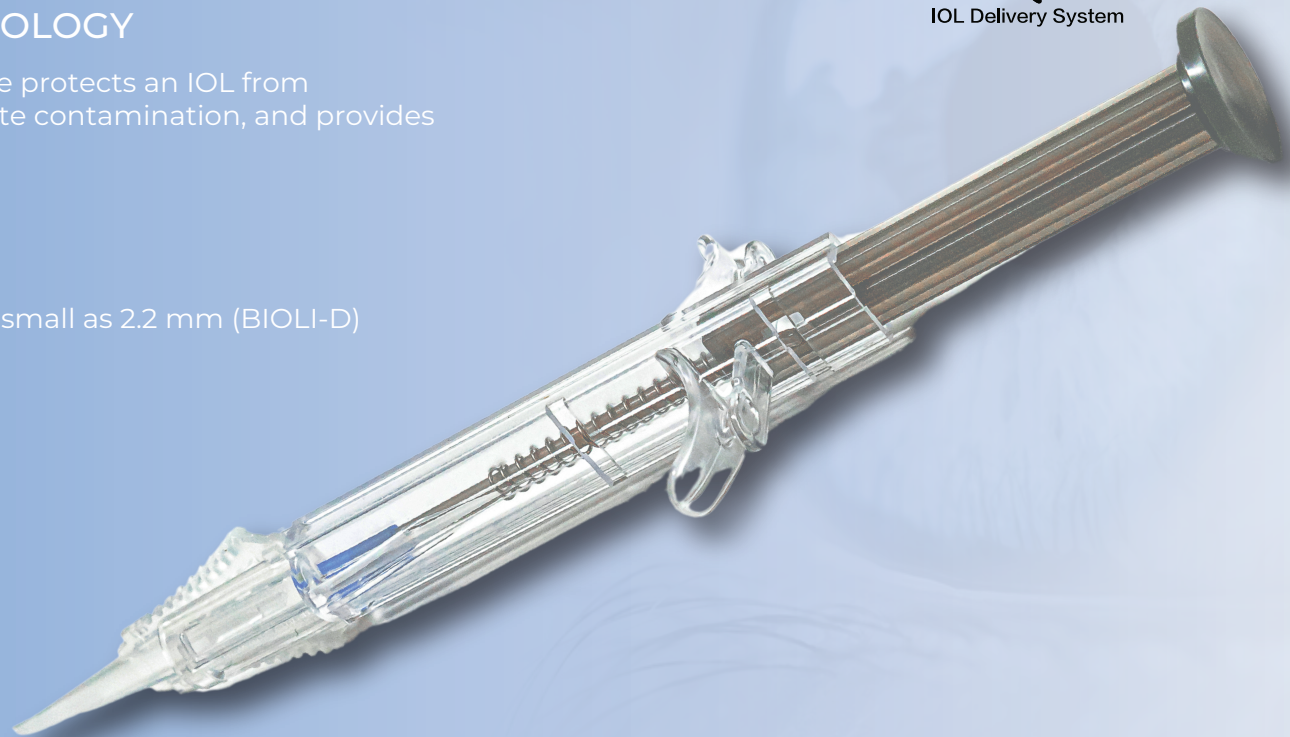

QUICK USER GUIDE

bioli™ IOL Delivery System

The delivery system consists of the injector (Figure 1) and the cartridge (Figure 2).

Figure 1. bioli™ injector

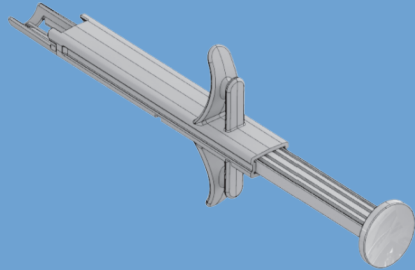
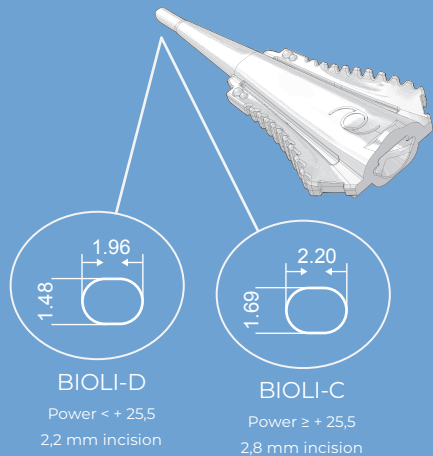
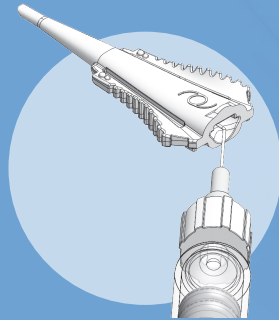

Figure 2. BL-Cart™ IOL Delivery Cartridge*.



*Compatible with Alcon Monarch® III IOL Delivery System injector



STEP 1

Position the cartridge with the implant drawing facing upwards and apply viscoelastic solution until the cartridge is completely filled.

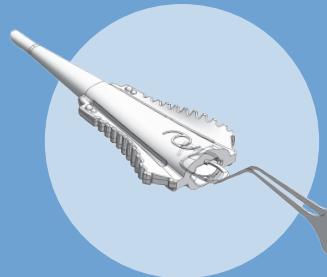

STEP 3

Use holding forceps, grasp the trailing haptic, and gently fold the haptic onto the anterior face of the optic.

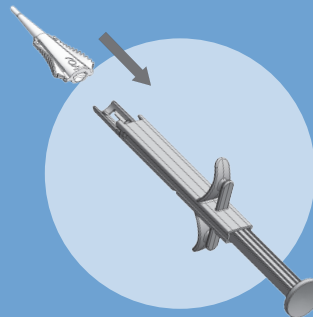

STEP 5

Insert the cartridge into the injector by sliding the cartridge backward into the injector slot until hearing a click.

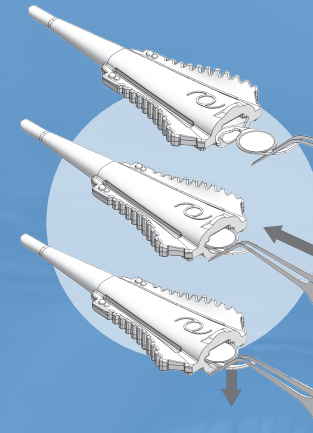

STEP 2

Use holding forceps to grasp the lens by the junction of optic and trailing haptic. Gently place the lens anterior side up into the rear of the cartridge and use the left internal feature to fold the leading haptic. Continue to advance the lens until the optic is a little more than half-way inside the cartridge.

Gently push down on the lens, verify that the lens is on the bottom surface of the cartridge.

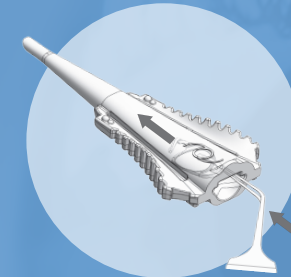

STEP 4

Slowly push the optic edge to position the lens as much into the cartridge as the forceps allow, while ensuring the lens remains on the bottom surface of the cartridge and the trailing haptic remains on top of the optic.

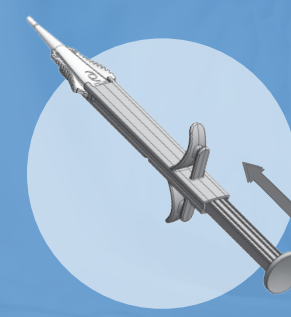

STEP 6

Carefully push the plunger forward, and advance the lens to the anterior edge of the cartridge. The bioli™ IOL Delivery System is now properly loaded and ready for use.

SURGICAL ADVICES

1. bioli™ IOL Delivery System is supplied with a C-size or D-size cartridge, depending on the IOL power (see figure 2). Prior to lens implantation, confirm that an appropriate incision is made for the corresponding cartridge size.
2. Insert the cartridge gently into the incision and proceed with the implantation, considering counterpressure with the opposite hand to the one holding the injector.
3. Push the plunger smoothly. As the peak resistance is reached, pause there for a moment, and then gradually apply force to the plunger again to finish the implantation.